

OPEN IMPELLER SLURRY PUMP

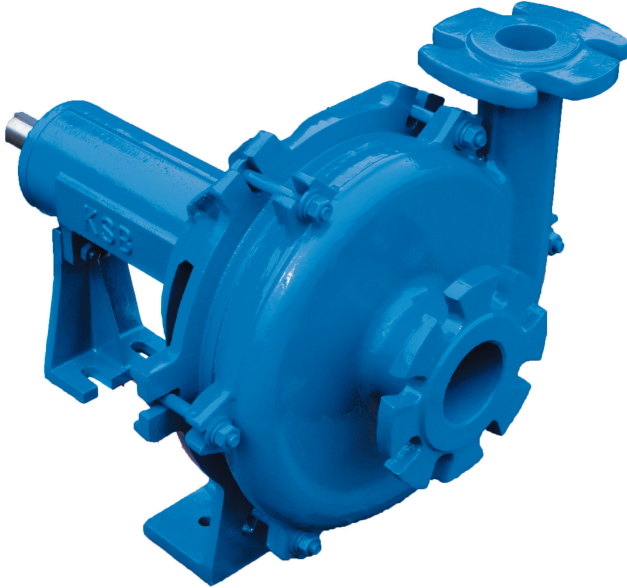

General Specification

Part List

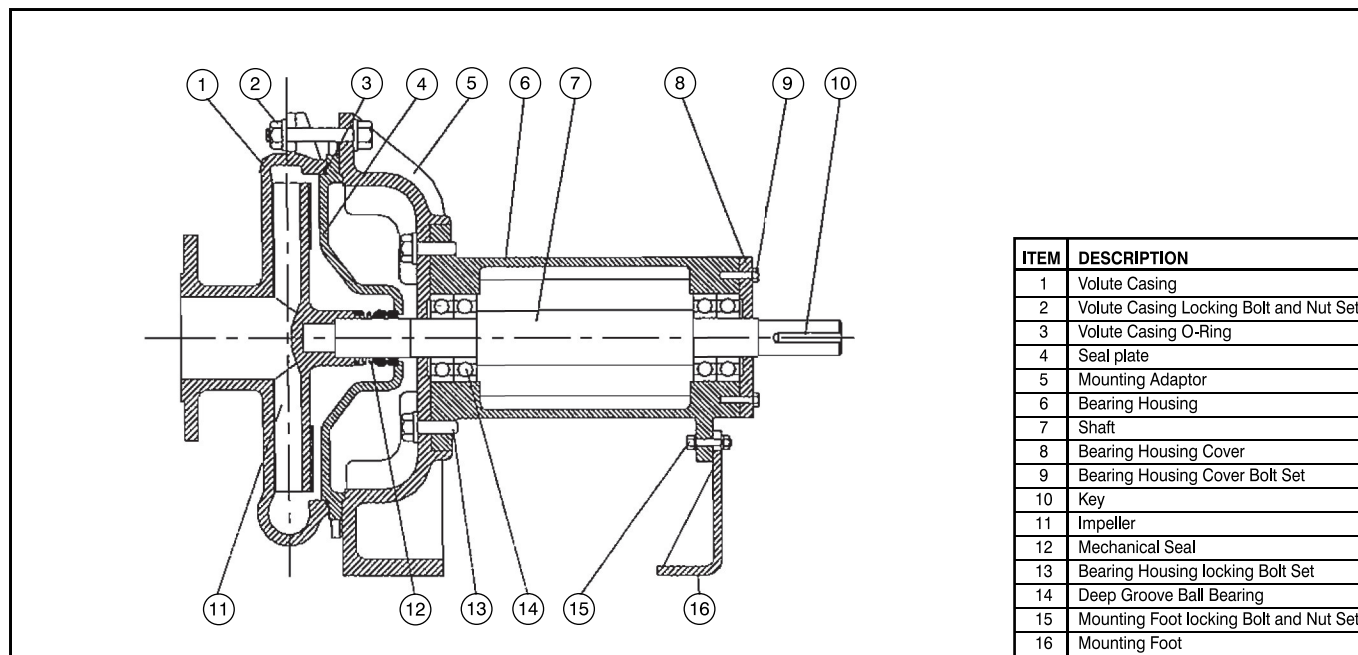

Capacity

- o up to 350 Meter³/Hour
- o up to 80 Meter Head
- o 700 rpm to 3,600 rpm
- o 8 Pump sizes
- o 5 Pedestal sizes
- o Max. solid size up to Ø50 mm

Design

- o Pumps with open impeller.
- o End Suction, Vertical Discharge
- o Back pull out design for easy maintenance.
- o All impellers have back vanes to reject solids from water box entering seal housing.
- o Vee pulley belt driven or direct coupled.
- o Flanges follow ISO 7005-2 1988E PN 16.
- o Coupling End complied with ISO Standard dimensions.

Material

- o Casing; Stainless Steel 304 as standard (Optional: Ni-Resist, Ductile, Cast Iron).
- o Bearing Pedestal Construction: Cast Iron.
- o Shaft: Stainless Steel 304.
- o Seal Housing : Stainless steel as standard (Optional: Ni-Resist, Ductile & Cast Iron).
- o Impeller : Stainless steel 304 as Standard (Optional: Ni-Resist, Ductile & Cast Iron)

Seal

- o Mechanical Seal -SIC V/S SIC faces or Carbon V/S Ceramic).
- o Gland Pack - BURGMANN or equivalent.

Bearing

- o Greased lubricated
- o Oil lubrication (available)

Working Temperature

- o 80°C
- o Maximum 120°C

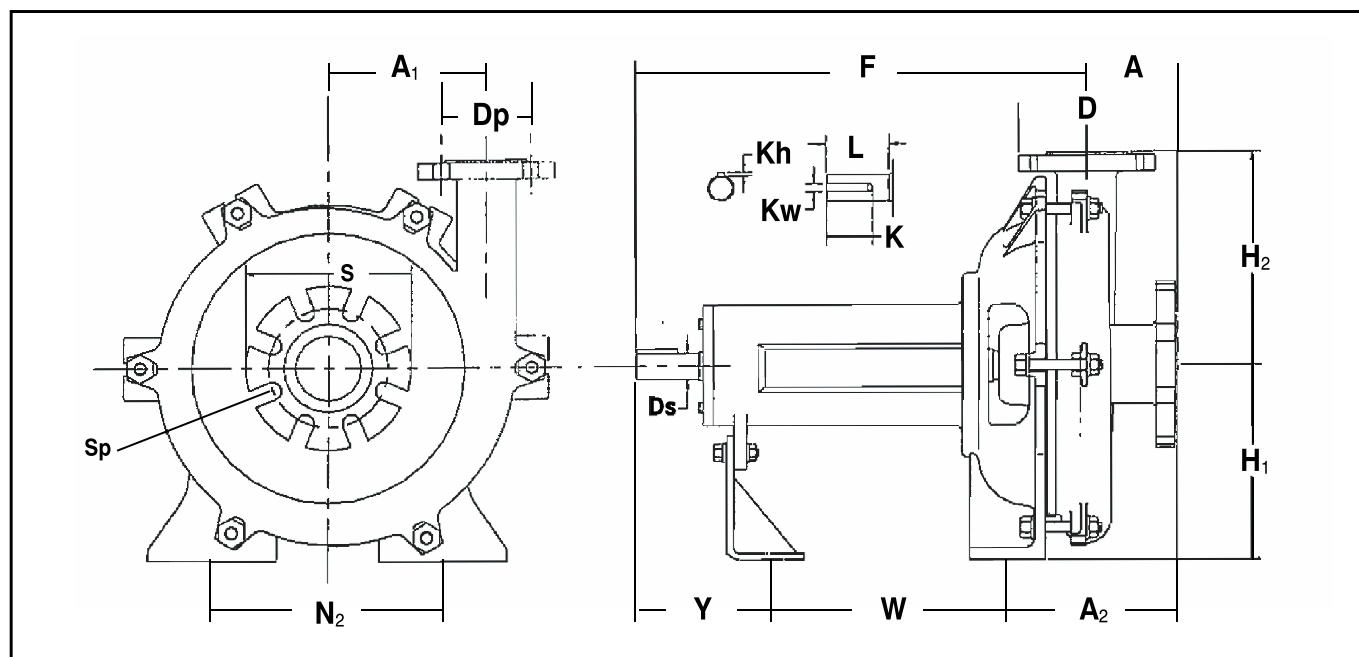

Type :	GENERAL DIMENSION																				Approx.
Mechanical Seal:	PUMP DETAILS															SHAFT DETAILS					Weight
MODEL	SucØ	DiscØ	F	A	A1	A2	S	Sp	D	Dp	H1	H2	W	Y	N2	Ds	L	K	Kh	Kw	Kg
32 - 330	40	32	508	105	181	204	150	110	140	100	285	220	255	154	258	32	80	63	8	10	94
40 - 330	50	40	510	106	185	207	165	125	150	110	285	220	255	154	258	32	80	63	8	10	96
50 - 280	80	50	515	100	165	206	200	160	165	125	226	219	255	154	215	32	80	63	8	10	81
50 - 330	80	50	510	98	190	199	200	160	165	125	285	220	255	154	258	32	80	63	8	10	99
75 - 300	100	75	564	130	188	250	240	220	200	160	285	258	246	198	258	42	110	80	8	12	115
75 - 420	100	75	632	110	248	210	240	220	200	160	295	245	334	198	300	42	110	80	8	12	154
100 - 300	150	100	650	130	202	248	285	240	240	220	285	247	334	198	258	42	110	80	8	12	128
100 - 300	150	100	643	155	225	266	285	240	240	220	285	255	334	198	258	42	110	80	8	12	142

AQUAFLOW SELECTION CHART

Please refer sales department for further detail on performance curves.

